

Big or small, Renfroe has it all.

Whether it's big, small or somewhere in between, if your operation depends on using the right size lifting clamp for the job, you need a Renfroe clamp. That's because J.C. Renfroe has an extensive selection of products with many rated lifting capacities. We're so determined that you find the right model for your lifting needs that, if you can't find it from our line of clamps, we'll happily engineer one specially suited

to your application. We even offer free safety surveys and training seminars for our customers. That's what comes from being tuned into our customers' needs and wants for more than 65 years. It's no wonder that outstanding customer service and on-time deliveries rank right up there with our being able to offer you the best quality lifting clamp in the industry.

For more information on how we size up, contact us today for an on-the-spot consultation about your lifting needs.



J.C. RENFROE & SONS

Giving Industry the Lift It Needs!

Jacksonville, FL USA
Fax 904-354-7865 • Toll-Free 800-874-8454

www.jcrenfroe.com



VERTICAL + 180 + SIDE PULL





Model JPA

Locking Type

The **Model JPA** is a vertical lifting clamp capable of turning a single plate or member from horizontal to vertical to horizontal through a 180 degree arc. Incorporates a push button auxiliary lock. Permits side loading of lifting shackle to 90 degrees by derating of clamp's rated capacity. Refer to FIGURE 1 for derated capacities.

Model JPA incorporates a pivoting shackle that permits side loading of the lifting shackle at 100 percent of rated capacity from vertical to 30 degrees, 75 percent of rated capacity between 30 and 45 degrees and 50 percent of rated capacity between 45 and 90 degrees.

MODEL JPA EXPLODED VIEW

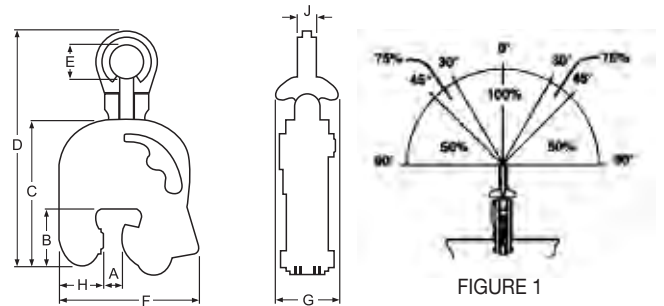
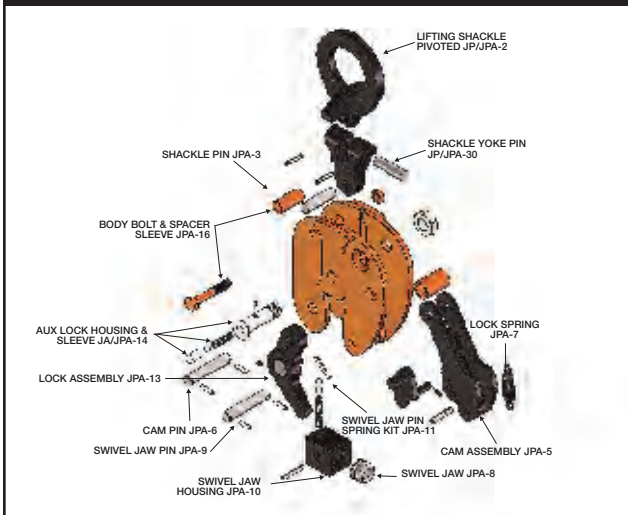

FIGURE 1

SPECIFICATIONS (in inches)

Rated Capacity Tons	Plate Thickness A	B	C	MAX. D	E	MAX. F	G	H	J	Weight (in pounds)
1/2	0-5/8	2 3/4	6 1/2	12	2 3/8	5 5/8	3 3/4	2 1/4	1 1/2	12
	5/8-1	2 3/4	6 1/2	12	2 3/8	6	3 3/4	2 1/4	1 1/2	
	1-1 1/4	2 3/4	6 1/2	12	2 3/8	6 1/4	3 3/4	2 1/4	1 1/2	
	1 1/4-1 3/4	2 3/4	6 1/2	12	2 3/8	6 3/4	3 3/4	2 1/4	1 1/2	
1	0-3/4	3 3/8	7 3/4	13 3/4	2 5/8	7	3 1/2	2 5/8	5/8	20
	3/4-1	3 3/8	7 3/4	13 3/4	2 5/8	7 1/4	3 1/2	2 5/8	5/8	
	1-1 1/4	3 3/8	7 3/4	13 3/4	2 5/8	8	3 1/2	2 5/8	5/8	
	1 1/4-2	3 3/8	7 3/4	13 3/4	2 5/8	8 1/4	3 1/2	2 5/8	5/8	
2	0-1	3 5/8	9 1/2	17 3/8	3 1/2	8 3/4	4 1/2	3	3/4	40
	1-1 1/2	3 5/8	9 1/2	17 3/8	3 1/2	9 1/4	4 1/2	3	3/4	
	1 1/2-2	3 5/8	9 1/2	17 3/8	3 1/2	9 3/4	4 1/2	3	3/4	
	2-2 1/4	3 5/8	9 1/2	17 3/8	3 1/2	10 1/2	4 1/2	3	3/4	
4	3/8-1 1/4	4 3/8	11 1/2	20 1/8	3 1/2	9 1/4	4 1/2	3 3/4	1 1/2	50
	1-2	4 3/8	11 1/2	20 1/8	3 1/2	10	4 1/2	3 3/4	1 1/2	
	2-3	4 3/8	11 1/2	20 1/8	3 1/2	11	4 1/2	3 3/4	1 1/2	
	3-4	4 3/8	11 1/2	20 1/8	3 1/2	12	4 1/2	3 3/4	1 1/2	
6	1/4-1 3/8	4 7/8	12 3/8	20 7/8	3 1/2	10 3/4	4 3/4	3 3/4	1 3/4	72
	1-2 1/8	4 7/8	12 3/8	20 7/8	3 1/2	11 1/2	4 3/4	3 3/4	1 3/4	
	2-3 1/8	4 7/8	12 3/8	20 7/8	3 1/2	12 1/2	4 3/4	3 3/4	1 3/4	
	3-4 1/8	4 7/8	12 3/8	20 7/8	3 1/2	13 1/2	4 3/4	3 3/4	1 3/4	
8	5/8-1 1/2	5 3/8	12 3/4	22 3/8	3 3/4	12 3/8	5 1/4	4 1/4	2	93
	1-2 1/8	5 3/8	12 3/4	22 3/8	3 3/4	13	5 1/4	4 1/4	2	
	2-3 1/8	5 3/8	12 3/4	22 3/8	3 3/4	14 3/8	5 1/4	4 1/4	2	
	3-4 1/8	5 3/8	12 3/4	22 3/8	3 3/4	15 3/8	5 1/4	4 1/4	2	
12	1 1/2-2 1/2	7 1/4	17 3/4	28 1/8	3 7/8	15 15/16	7 1/8	5 3/8	2	203
	2-4	7 1/4	17 3/4	28 1/8	3 7/8	17 1/16	7 1/8	5 3/8	2	212
	4-6	7 1/4	17 3/4	28 1/8	3 7/8	19 1/16	7 1/8	5 3/8	2	222
16	1 1/2-2 1/2	8	19 13/16	32 5/8	4 1/2	19 13/16	8 11/16	6 1/4	2 1/4	350
20	1 1/2-3	8 5/8	21 13/16	35 7/8	5	21	11 1/2	6 7/8	2 3/4	456
25	1 1/2-2 1/2	8 5/8	23 5/8	35 7/8	5	19 1/16	9 5/8	6 3/4	3	483
	3-5	8 5/8	23 5/8	35 7/8	5	21 1/16	9 5/8	6 3/4	3	495
	4-6	8 5/8	23 5/8	35 7/8	5	22 3/16	9 5/8	6 3/4	3	502
30	1 1/2-3	9 9/16	24 1/4	39 7/8	5	22 13/16	14 9/16	7 5/8	3	625
50	3-5	10 7/8	30 7/8	46 7/8	5	29 3/8	11 1/8	9 1/4	3 1/2	1306

Consult factory for possible larger capacities. SPECIFICATIONS ARE SUBJECT TO CHANGE WITHOUT NOTICE



Model LPA

Model LPA is an ergonomic vertical lifting clamp capable of turning a single plate or member from horizontal to vertical to horizontal through a 180 degree arc. It incorporates an auxiliary push button lock. Permits side loading of lifting shackle to 90 degrees by de-rating of clamp's capacity. Refer to FIGURE 1 for de-rated capacities. The "Lock Open – Lock Closed" feature facilitates attaching and removing the clamp from the plate.

The **Model LPA** incorporates a pivoting shackle that permits side loading of the lifting shackle at 100 percent of rated capacity from vertical to 30 degrees, 75 percent of rated capacity between 30 and 45 degrees, and 50 percent of rated capacity between 45 and 90 degrees.

MODEL LPA EXPLODED VIEW

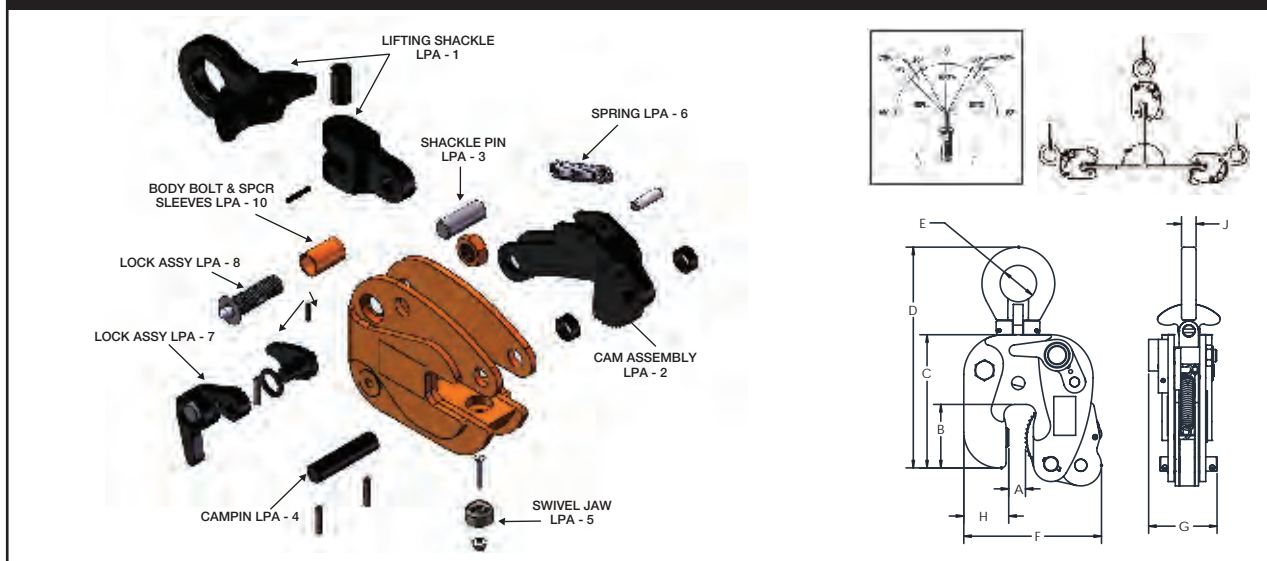

SPECIFICATIONS (in inches)

Rated Capacity Tons	Plate Thickness A	B	C	MAX. D	E	MAX. F	G	H	J	Weight (in pounds)
1/2	0-5/8	2	5 1/16	8 11/16	1 1/8	4 1/4	2 7/16	1 3/8	3/8	4 1/8
1	0-3/4	2	5 1/8	8 11/16	1 1/8	4 3/8	2 7/16	1 3/8	1/2	5 1/8
2	0-1	3 5/16	6 7/8	12 1/2	1 7/8	7 1/16	3 5/8	2 3/8	3/4	16 7/8
3	0-1	3 7/16	10	17	3 5/8	8 1/2	3 13/16	2 3/4	3/4	32

Consult factory for possible larger capacities. SPECIFICATIONS ARE SUBJECT TO CHANGE WITHOUT NOTICE



Model SCPA

Locking, Screw Type

The **SCPA** clamp is capable of handling steel plate from horizontal to vertical to horizontal through a 180 degree arc and may be used for handling plate at rolling and forming machines. These clamps feature a spring loaded pivoting cam jaw that "cams in" when a load is applied to the lifting shackle. Clamp is capable of handling plate horizontally when used in pairs or sets of pairs, or in a tripod arrangement.

*Pivoting shackle assembly, as shown, is available on capacities 3 tons and larger.



MODEL SCPA EXPLODED VIEW

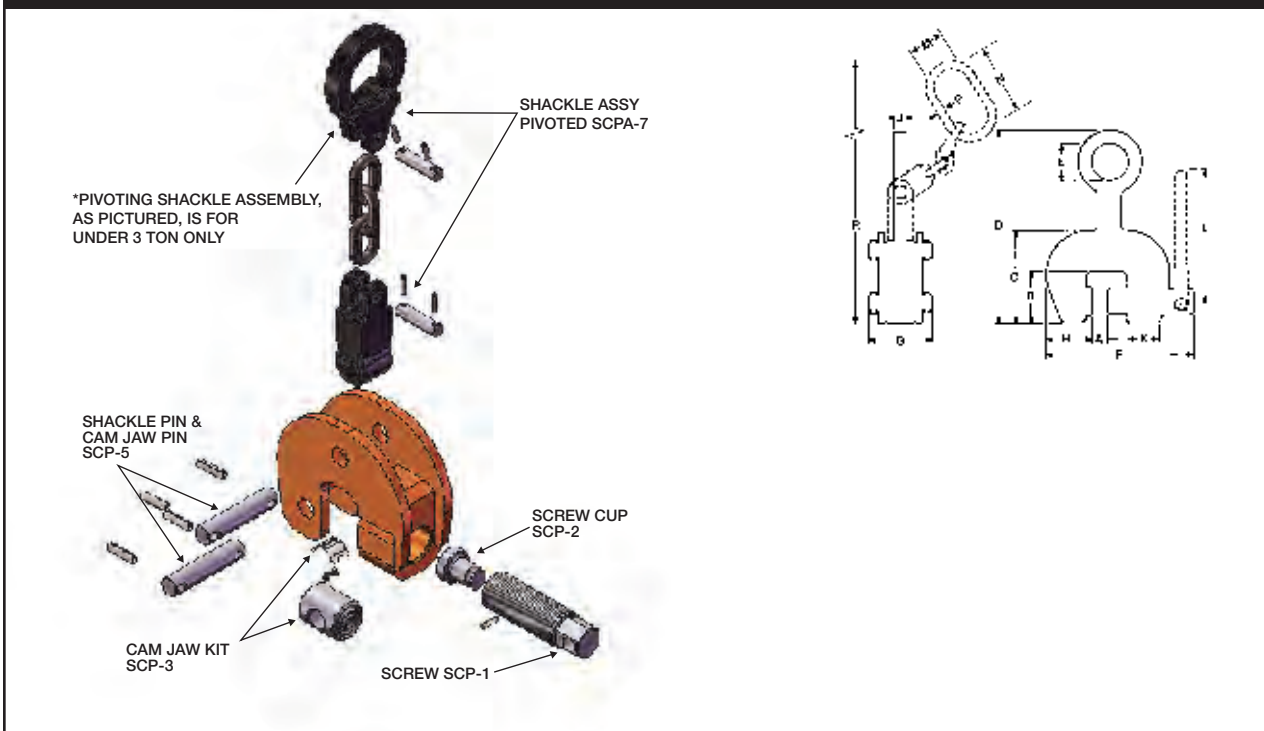

SPECIFICATIONS (in inches)

Rated Capacity Tons	Plate Thickness A	B	C	E	F	G	H	J	K	L	Weight				
											M	N	P	R (in pounds)	
1/2	0-3/4	2 3/8	4 1/2	2 3/8	6 5/8	2 3/8	1 7/8	1/2	1 1/2	—	1 3/4	1 3/4	9/16	12 3/16	8
1 1/2	0-1 1/4	2 7/8	5 1/2	2 5/8	8 7/16	3 3/8	2 3/8	5/8	1 3/4	8 1/4	2	2	1 1/16	14 3/16	15
3	0-2	3 1/8	5 3/4	2 3/8	10 13/16	4 1/8	2 13/16	3/4	2	8 5/8	3	6	3/4	21 3/8	24
6	0-2 1/2	4 5/16	7 9/16	3	14 3/8	5 3/8	3 7/16	1	2 15/16	—	3 1/2	7	1	27 3/4	57
10	0-3	5 1/2	9 3/4	3 1/4	16 3/8	6 3/4	4 3/8	1	3 1/8	—	3 1/2	7	1	29 7/16	134
15	0-4	7 1/4	12 1/8	3 3/4	21 1/2	8 1/4	5 9/16	1 1/4	4	—	3 7/8	8	1 1/4	36 1/2	312

20, 30, 50, 100 and 150 Ton capacities available upon request. SPECIFICATIONS ARE SUBJECT TO CHANGE WITHOUT NOTICE.